

Model IFC Gate Valves

Industry Proven design gate valves with non rising stem built in accordance with ISO 10423 (API6A)

Full range of sizes, pressure ratings and materials classes these valves are available for manual, hydraulic or pneumatic operation

Features:

1. Packing retainer allows for replacement of bearings or stem pin whilst valve is under pressure
2. Injection port allows for lubrication of gate and seat assembly and may be used to relieve trapped pressure after the stem has been backseated
3. Range of materials for both body and trim
4. Manual and/or Hydraulic operation
5. Thrust bearings reduce operating torques
6. Shear pin prevents excessive loads being applied via the handwheel and protects internal parts from damage
7. Shoulder on the stem may be backseated against the bonnet to seal the stuffing box permitting replacement of stem packing
8. Gate and Seat assemblies may be simply and quickly replaced without the requirement of any special tools
9. Gate construction is designed to prevent line sediments from entering the body cavity and is designed to prevent pressure locks when the upstream pressure is reduced

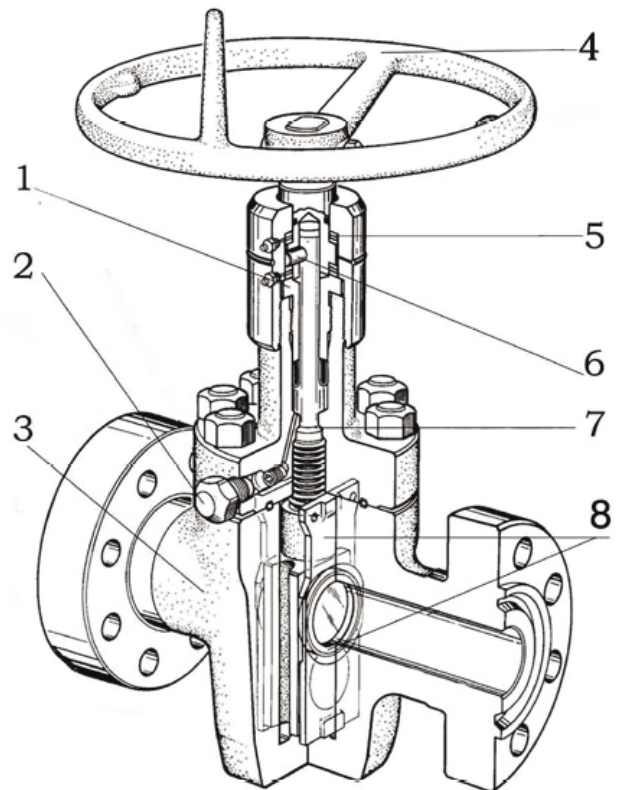

Specifications

Materials of Construction Model IFC Gate Valve 2000 to 15000psi 1-13/16" to 7-1/16"

Service Conditions	Trim Material Class	Pressure Rating Mpsi	Material						
			Body & Bonnet	Bonnet Gasket	Gate		Seat		Stem
					Material	Surface Treatment	Material	Surface Treatment	
General Non-Corrosive	AA	2,3,5	Low Alloy API 60K	UNS S30400 or UNS S31600	UNS G41300	E.N.P.	UNS G41300	E.N.P. / Nitriding	Low Alloy
		10	API 75K	Nitrided		n/a		UNS S41000	
		15		Hard faced		Stellite 6			
General Low CO ₂ SS trim	BB	2,3,5	Low Alloy API 60K	UNS S30400 or UNS S31600	UNS S41000	Nitrided	Stellite 6	n/a	UNS S41000 or UNS S17400
		10	API 75K	E.N.P.					
		15							
No H ₂ S SS trim	CC	2,3,5	UNS S41000	UNS S30400 or UNS S31600	UNS S41000	Nitrided	Stellite 6	n/a	UNS S41000 or UNS S17400
		10				E.N.P.			
		15							
Sour H ₂ S Non-Corrosive	DD	2,3,5	Low Alloy API 60K	UNS S30400 or UNS S31600	UNS G41300	Stellite 6 or Nitrided	UNS G41300	Hard facing / Nitriding	Low Alloy or UNS S17400
		10	API 75K	Stellite 6			n/a		
		15							
Sour H ₂ S Slight-Corrosive	EE	2,3,5	Low Alloy API 60K	UNS S30400 or UNS S31600	UNS S41000	Nitrided	Stellite 6	n/a	UNS S41000 or UNS S17400
		10	API 75K	E.N.P.					
		15							
Sour H ₂ S Corrosive	FF	2,3,5	UNS S41000	UNS S30400 or UNS S31600	UNS S41000	Hard faced	Stellite 6	n/a	UNS S17400
		10							
		15							
Sour H ₂ S High Corrosive	HH	2,3,5	UNS G41300 with UNS N06625	UNS N06625	UNS N06625		UNS N07718		UNS N07718
		10							
		15							

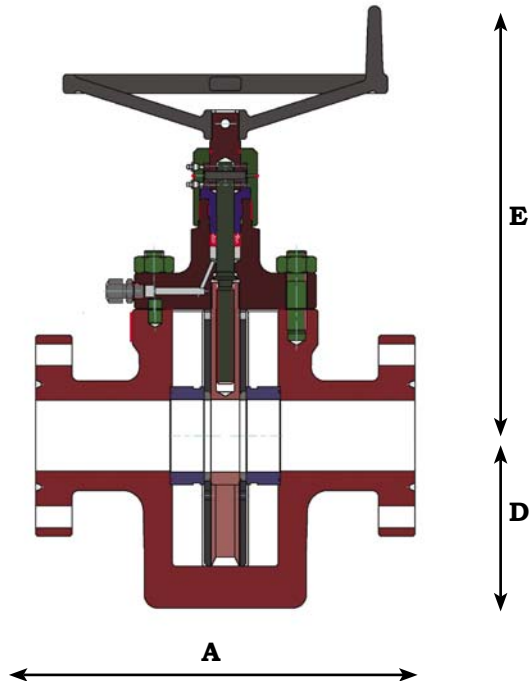
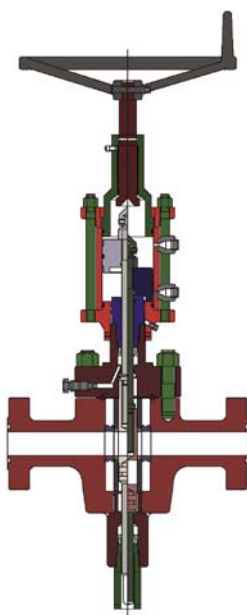

Dimensions

Dimensional Data Model IFC Gate Valve 2000 to 1500psi 1-13/16" to 7-1/16"

Dimensions		Size							
		1-13/16	2-1/16	2-9/16	3-1/16	3-1/8	4-1/16	5-1/8	7-1/16
A Face to face mm	3M threaded		269.9	341.3		346.1			
	3M Flanged		371.5	422.3		435.0	511.2		714.0
	5M threaded		269.9	341.3		346.1			
	5M Flanged		371.5	422.3		473.1	549.3	726.9	813.0
	10M Flanged	469.9	520.7	565.2	619.1		669.9	736.6	889.0
	15M Flanged	457.2	482.6	533.4	598.5		736.6		
B Body width mm	3M Flanged		171.5	193.7		190.5	266.7		380.0
	5M Flanged		177.8	208.0		235.0	274.6		356.0
	10M Flanged	230.2	238.1	249.2	260.4		325.4	390.0	478.0
	15M Flanged	250.8	250.8	292.1	344.5		390.5		
C Centre of bore to top stem adaptor mm	3M Flanged		330.2	401.6		427.0	468.3		950.0
	5M Flanged		384.2	401.6		427.0	468.3		967.0
	10M Flanged	384.2	384.2	401.6	428.6		500.1	920.0	1000.0
	15M Flanged	384.2	384.2	436.6	531.8		579.4		
D Centre of bore to bottom of body mm	3M Flanged		142.9	165.1		187.3	231.8		320.0
	5M Flanged		142.9	165.1		187.3	231.8		324.0
	10M Flanged	146.1	149.2	173.0	204.8		255.6	619.0	416.0
	15M Flanged	149.2	155.6	185.7	235.0		258.8		
E Centre of bore to top of handwheel mm	3M Flanged		390.5	409.6		484.2	525.5		460.0
	5M Flanged		441.3	460.4		484.2	525.5		967.0
	10M Flanged	441.3	441.3	460.4	458.8		531.8	765.0	1000.0
	15M Flanged	441.3	441.3	496.9	563.6		611.2		
F O.D. of handwheel mm	3M Flanged		355.6	355.6		355.6	469.9		609.0
	5M Flanged		355.6	355.6		469.9	469.9		609.0
	10M Flanged	355.6	469.9	469.9	609.6		609.9	609.0	870.0
	15M Flanged	469.9	469.9	469.9	609.6		609.9		
Turns to open / close	3M Flanged		12-1/2	15		18	23		37-1/2
	5M Flanged		12-1/2	15		18	23	29	37-1/2
	10M Flanged	12	12-1/2	15	18		29	30	37-1/2
	15M Flanged	12	12-1/2	15	15				
Weight Kg	3M threaded		59	84					
	3M Flanged		82	113			205		550
	5M threaded		59	86		95			
	5M Flanged		83	116		128	248	534	556
	10M Flanged	123	125	220	309		480	773	1453
	15M Flanged	125	160	364	484	164	591		
Ring Number	3M Flanged		R-24	R-27		R-31	R-37		R-45
	5M Flanged		R-24	R-27		R-35	R-39		R-46
	10M Flanged	BX-151	BX-152	BX-153	BX-154		BX-155	BX-169	R-156
	15M Flanged	BX-151	BX-152	BX-153	BX-154		BX-155		

Automation

In Line Valve Gate Valves are provided with:-

- Manual configuration
- Double acting hydraulic actuator
- Single acting hydraulic with spring close actuator for use as surface safety valve
- Self contained fail close hydraulic actuator for use as emergency shut down valve
- Pneumatic actuator

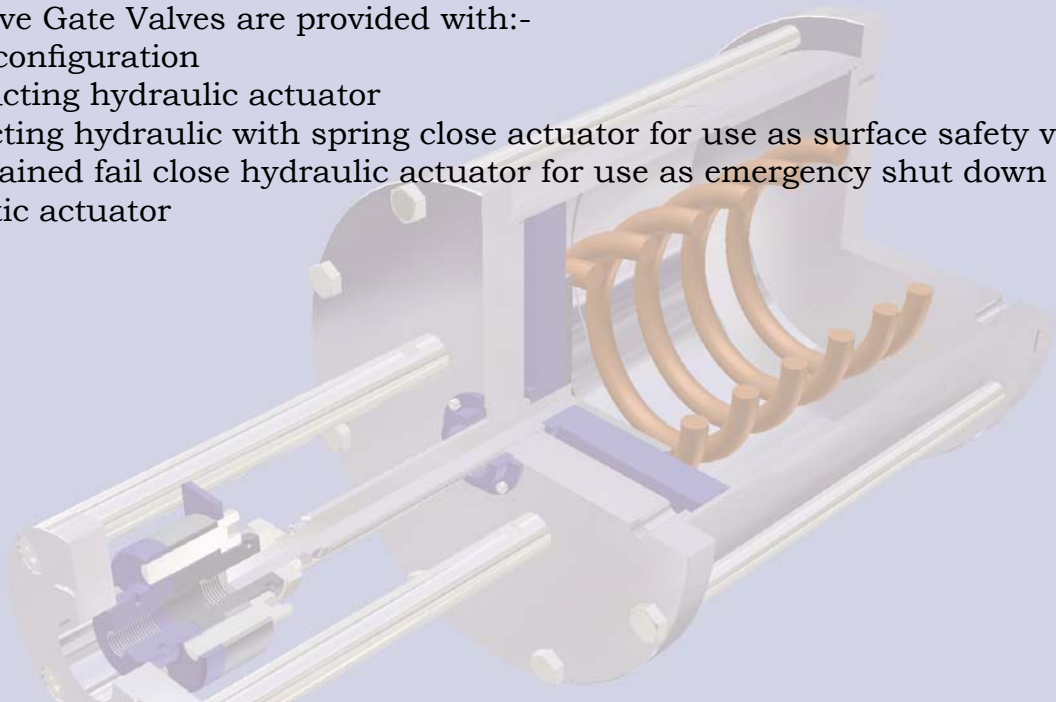

In Line Valve Chokes & Control Valves



In Line Valve Company Ltd
Reading
RG7 6RF
UK

Tel. +44 1635 863491
Fax +44 1635 871528
sales@inlinevalve.co.uk

In Line Valve Sdn Bhd
Kuala Lumpur
Malaysia

sales@in-linevalve.com

Further information is available at www.inlinevalve.co.uk ,